



Indian Railway Stations Development Corporation Limited
(A JV of IRCON International Ltd & Rail Land Development Authority)

- Notes:
- All dimensions are in mm. The dimensions are to be read and not scaled/measured from the drawings.
 - All structural, mechanical and electrical drawings shall be read jointly with the architectural drawings in order to establish a complete list of works.
 - The contractor shall verify all dimensions, details, specifications & site conditions & shall report any error, omission and/or anomaly to the architect before commencement of work.
 - For construction purposes, the dimensions shall not be measured directly on the drawings. The drawings shall not be used for construction until they are issued as good for construction.
 - All door and window openings shall be verified as per schedule. Furniture and fixtures shown are indicative only. Materials to be given as per specifications. Please refer respective detail drawings and schedules.
 - This drawing, as an instrument of service, is the exclusive property of AECOM and may not be reproduced and/or copied without prior permission. The information shown on this drawing is for use on the specified project only, and shall not be used otherwise.
 - Height of plinth shall be 840mm above the rail head level at platform 1.
 - All surfaces of walls should be plastered with 20mm thick (1:6).
 - All flooring to be as per specifications.
 - In toilets floor shall be kept 25mm lower than main plinth.
 - Schedule 9 of development agreement and IRWM to be followed for carrying out all works and finishes. Contractor shall notify any discrepancy to architect prior to commencement of works.
 - Latest versions of Indian railway manuals IRPWM and IRACTM to be followed to carry out all works.
 - All safety regulations to be followed as per requirements prescribed as per various standards and procedures of Indian Railways.
 - Contractor to ensure compliance with all applicable regulations and continuous protection of all personnel on site.

Glazing/Window Schedule			
Type Mark	Width	Sill Height	Lintel Height
DG	19800	00	2400
DG1	5880	00	2575
DG2	4800	00	2400
DG3	2970	00	2400
G	24240	420	3575
G4	3200	2075	3575
G4'	3200	1775	3275
G5	3200	300	2400
G5'	3200	300	2400
G6	3800	300	2400
G7	1470	2075	3575
G8	1470	300	2400
G9	3200	2400	3900
G10	2500	2400	3900

Door/Ventilator Schedule			
Type Mark	Width	Sill Height	Lintel Height
D1	2000	00	2400
D2	1800	00	2400
D3	750	00	2400
D4	1200	00	2400
D5	1200	00	2400
D6	1000	00	2400
D7	900	00	2100
D8	750	00	2100/2275
D9	750	00	2100
D10	1200	00	2400
FD1	2000	00	2400
FD2	1500	00	2400
FD3	2000	150	2400
FD4	600	300	2400
FD5	900	150	2400
FD6	750	150	2400
FD7	1200	0	2400
V1	4500	2075	3575
V2	3200	2075	3575
V3	420	2075	3575
V4	4500	1000	3900
V5	3200	900	2400
V6	500	3225	3575
V7	500	4600	4950

Drawings issues

FOR ISSUES: DATE: RWD:

Key plan

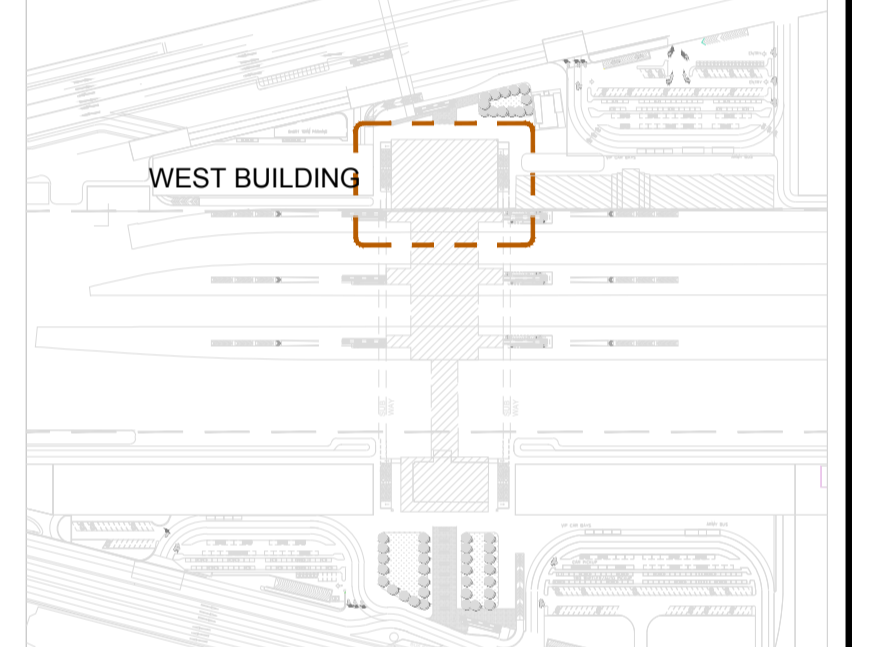

IT IS CERTIFIED THAT BEFORE PREPARATION OF GAD DETAILED INSPECTION OF SITE HAS BEEN CARRIED OUT AND ALL RELEVANT FACTORS HAVE BEEN CONSIDERED WHILE FINALIZING CONSTRUCTION SCHEME FOR THE BUILDING. IT IS CERTIFIED THAT THERE WILL BE NO DIFFICULTY IN EXECUTION OF WORK WITH PROPOSED SCHEME.

DGM(C) / BPL

IRSDC's Approval

Approval By: Lead Design Checker

Approval By: Project lead (AECOM)

Client: **Bansal Pathways Habibganj Private Limited**
3rd Floor, Tawa Complex, Bittan Market,
Arera Colony, Bhopal
Madhya Pradesh - 462016
T: 755-242376

ASMEPF Consultants: **AECOM India**
9th Floor, Infinity Tower- 'C', DLF Cybercity, DLF Phase 2, Gurgaon,
122002
T: +91 124 4830100
F: 91 124 4830108
Email: www.aecom.com

Project title: **Development / Redevelopment of Habibganj Railway Station on the Indian Railway Network**

Drawing Title: **WEST BUILDING Mezzanine Floor - Commercial Concept Layout**

Scale: 1:150 Location: Habibganj Station, Bhopal
Drawn by: NG Date: 30/09/2020

Checked by: JKB Drawing No: HBJ-ACM-WB-A-MF-102

Drawing Status: P Preliminary Design D Definitive Design C Construction Design

Discipline: ARCHITECTURE

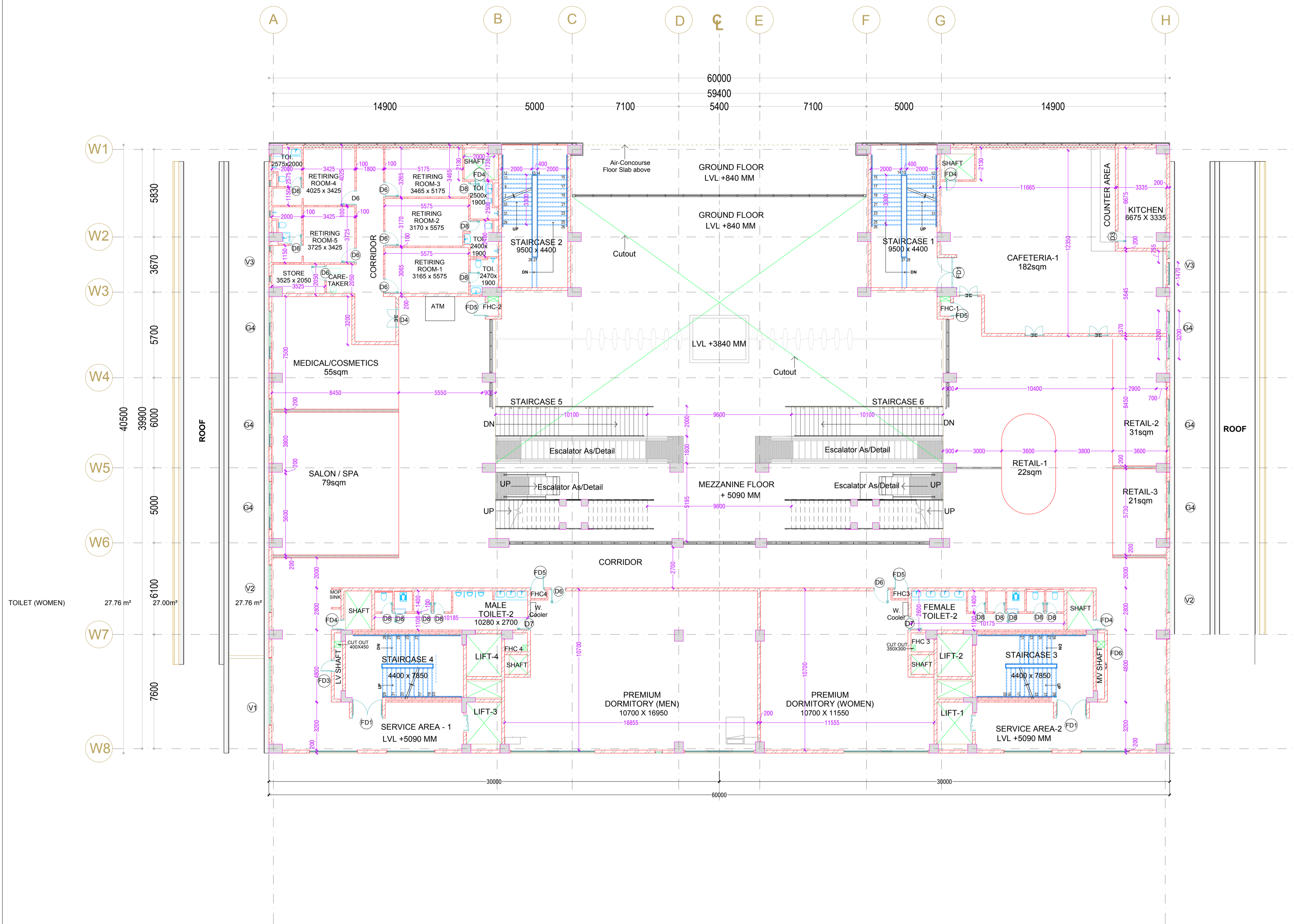

Proposed Side Blocks (West Side) Mezzanine Floor Level		
Description	Area as per development Agreement	Area as Proposed plan
CAFETERIA-1	289.5 m ²	146.90 m ²
ESCALATOR -1	21 m ² Total	25 m ² Total
ESCALATOR -2	21 m ² Total	25 m ² Total
KITCHEN	34 m ²	33.15 m ²
LIFT-1	6.25 m ²	6.51 m ²
LIFT-2	6.25 m ²	7.77 m ²
LIFT-3	6.25 m ²	6.51 m ²
LIFT-4	6.25 m ²	7.77 m ²
PREMIUM DORMITORY (WOMAN)	102.00 m ²	103.14 m ²
PREMIUM DORMITORY (MAN)	154.00 m ²	
RETIRING ROOM	127.00 m ²	316.85 m ²
STAIRCASE 1	142.00 m ² Total	142.00 m ² Total
STAIRCASE 2		
STAIRCASE 3		
STAIRCASE 4		
STAIRCASE 5		
STAIRCASE 6		
TOILET (MEN)	27.00m ²	27.76 m ²
TOILET (WOMEN)	27.00m ²	27.76 m ²
TRANSITION AREA-1	370.21 m ²	376.21 m ²
MEDICAL SHOP		37.4 m ²
SALON / SPA		79 m ²
SERVICE AREA -1	69.00 m ²	91.77 m ²
SERVICE AREA -1	69.00m ²	93.34 m ²
RETAIL-1	127.00 m ²	22.00 m ²
RETAIL-2		21.00 m ²
RETAIL-3		31.00 m ²

1 Mezzanine Floor Plan
Scale - 1 : 150